

Bottle-Matic Label Applicator

Ideal for applying pressure-sensitive labels to cylindrical objects

Bottle-Matic bottle labelers enable you to label all kinds of cylindrical objects by simply inserting the container and depressing a footswitch. Labels are applied at over 4.5" per second – most water bottles are labeled in less than two seconds. The operator then remove the bottle and inserts another to start the procedure again. After a rhythm is established bottles can be labeled very quickly.

- Label objects from 0.5" to 10" diameter; ideal for test tubes to 1.5-gallon bottles.
- Accurate: Maintains 0.0625" side-to-side accuracy on most containers.
- Labels cylinders to 15" in length (or longer if the item has a neck)
- Able to handle most tapered containers by simply adjusting the idle roller position.
- Labels over 1000 pieces per hour with average dexterity.
- Side frames are laser cut from quality steel, then formed, countersunk, deburred and inspected.
- Dispensing tables are formed out of 6061-T6 aluminum. Its peel edge is hand-milled to spec within .001".
- Dispensing tables are polished with ultra-fine polishing compound so paper flows freely around the plate.
- Bottle-Matic uses dual AC-shaded pole gear motors.
- Micro-switch activated; will work on all kinds of labels.
- Modifications are available for those hard-to-label containers.



Weber
Labels & Labeling Systems

Bottle-Matic Label Applicator

	Bottle-Matic 10" Applicator	Bottle-Matic 16" Applicator
Size (LxWxH)	15" x 17" x 8"	21" x 17" x 8"
Weight	17 lbs. (packaged weight 32 lbs.)	28 lbs. (packaged weight 38 lbs.)
Voltage	115v/220v	
Container Diameter	0.5" to 10"*	
Label Requirements	Die cut labels printed in copy position #3 or #4. Minimum width of backing paper should be 1.5". Must have an 0.125" gap between labels on a 3" core.	
Label Width	0.5" to 8"	0.5" to 15"
Label Length	0.5" to 25"	
Labeling Speed	4.5" plus per second	
Production Per Hour	1000 pieces using a 7" long label**	
Label Thickness	Most labels 4 mil or thicker including Mylar, foil and acetate labels.	
Max Roll Diameter	Standard 9"; optional 15" roll adapter	
Max Roll Weight	None	
Actuation	Semi-automatic with footswitch and solid-state controls (push-button optional at no additional charge)	

**Smaller diameter (less than 1.5") or lighter-weight empty plastic bottles may require the use of the pressure arm included with the machine.
**Actual production will depend on the operator efficiency in placing and removing containers to be labeled.*

Weber
Labels & Labeling Systems

Weber Packaging Solutions, Inc.

711 West Algonquin Rd. • Arlington Heights, IL 60005-4457 • 847.364.8500 • FAX 847.364.8575

www.weberpackaging.com



Economical automatic labeling system.

Reliable Design

Weber's Alpha Compact label applicator is a cost-effective solution for fast, easy-to-use pressure-sensitive labeling. This system features a small footprint, yet employs a highly-accurate wipe-on method of application to affix pressure-sensitive labels to your products or packaging.

The Alpha Compact unit automatically unwinds the supply roll and peels the labels from their liner, then wipes them on to products, cartons and other packages as they travel past the system on a conveyor line.

Versatile Labeling

This system applies labels up to 4.7" wide and 11.8" long at speeds up to 164 feet per minute to a tolerance of ± 0.03 ".

The Alpha Compact can be oriented to apply labels to the sides, tops or bottoms of packages. To accommodate various production environments, it can be specified for right- or left-hand applications.

The integrated controller allows the Alpha Compact to store labeling settings such as start/stop, single label feed, speed control, sensor calibration and more. Using a PC computer, you can create settings and load them via a USB drive or with a Cat5 network connection.

Special Features

- Applies labels from 0.47" x 0.78" up to 4.7" wide x 11.8" long
- Operates at speeds up to 164 feet/minute
- Applies labels to the tops, bottoms or sides of packages
- Accurate labeling to within ± 0.03 "



Weber[®]
Packaging Solutions

Alpha Compact *General Specifications*

Dimensions

28.15" x 12.2" x 23.22"
(715mm x 310mm x 590mm)

Weight

48.5 lbs. (22kg)

Electrical

115/230 VAC, 47/63Hz

Product Sensing

Photoelectric

Label Roll Size

Up to 12" O.D. (300mm) wound on 3"
(76mm) core

Label Styling

Die-cut, waste-removed with a minimum of
0.125" (3mm) separation between labels in
running direction

Label Placement

Accurate to $\pm 0.03"$ (0.8mm) when labels
are produced to specifications and product
handling is controlled

Standard Label Sizes

Min width: 0.4" (10mm)
Max width: 4.7" (120mm)
Min length: 0.78" (20mm)
Max length: 11.8" (300mm)

Labeling Speed

Up to 164 fpm (50m) depending on label
roll width and diameter

Options

- Adjustable stand
- Encoder
- Low-label sensor
- Three-color stack light

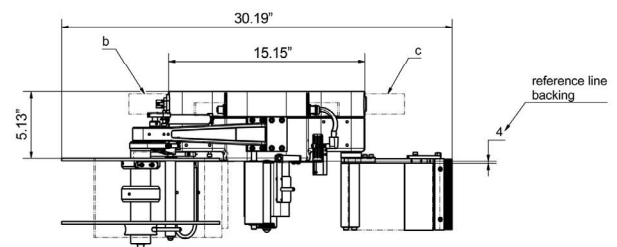
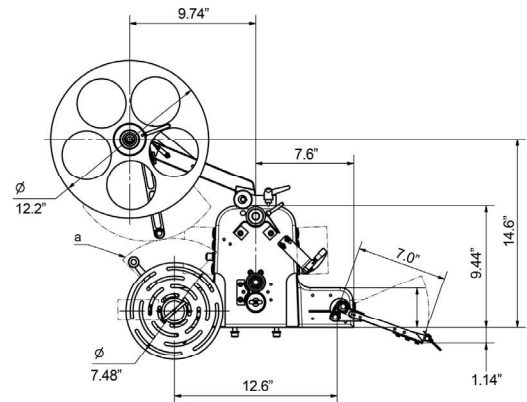
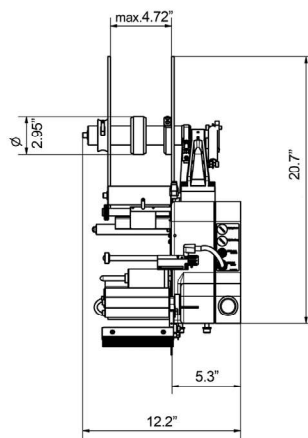

Three Interfaces

Depending upon the complexities and demands of the particular labeling operation, the Alpha Compact is available with three separate interfaces:

- Panel HMI includes an external operator's panel that provides system control through a pair of potentiometers and four push-buttons.
- Display HMI replaces the operator's panel with an LCD display that provides full access to all adjustment parameters.
- USB utilizes a USB connection that permits the unit to be configured from a PC.



Each version of the Alpha Compact features rugged die-cast aluminum construction, single-key calibration, automatic recognition of missing labels, in-production speed adjustment, and more.

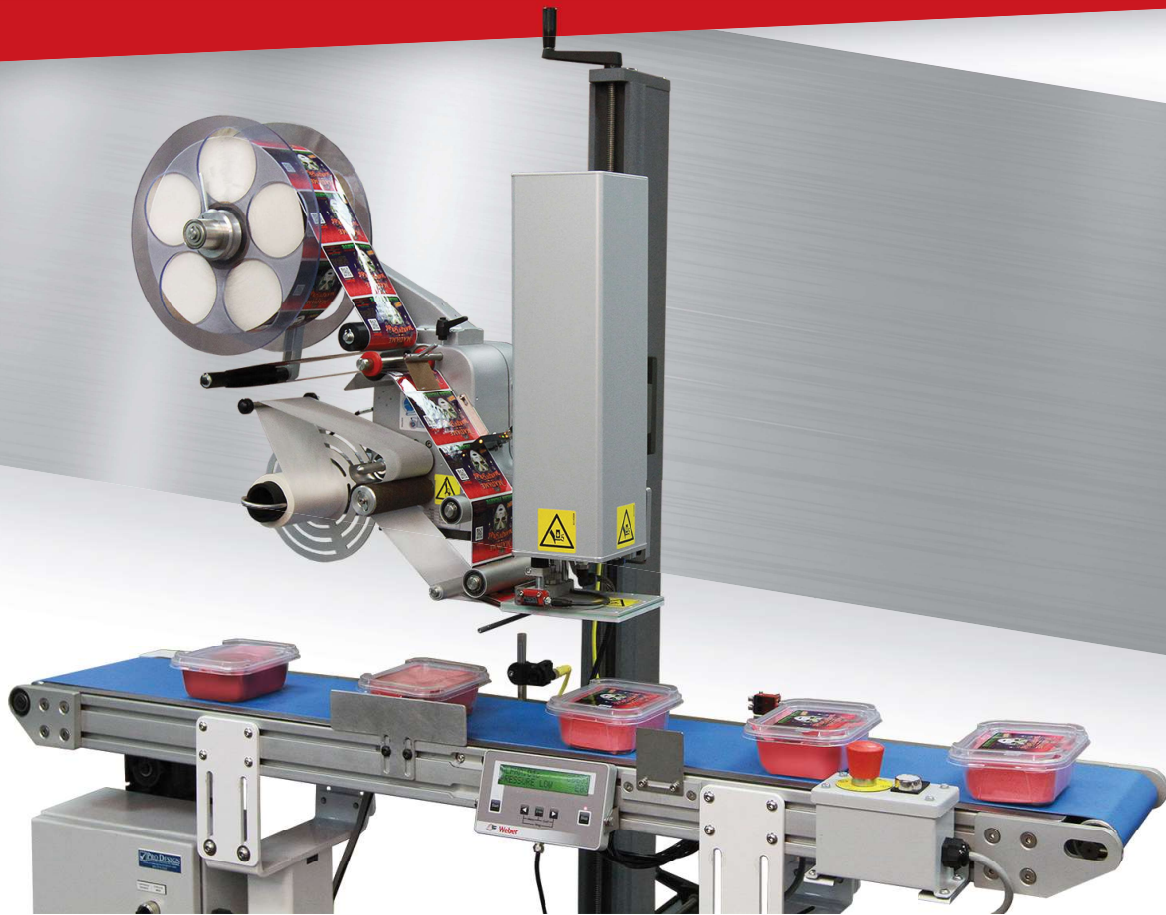

Recessed package labeling system.

Tamp-Blow Accuracy

Weber's Alpha Compact Tamp-Blow label applicator is a reliable solution to fast, non-contact pressure-sensitive labeling. This system features a small footprint, yet employs a highly-accurate tamp-blow method of application to affix p-s labels onto products on your production line.

The Alpha Compact tamp-blow unit automatically unwinds the supply roll and dispenses the labels onto a tamp pad. As the product coming down the conveyor triggers a sensor, the tamp pad holding the label extends to the product.

Versatile Labeling

A proximity sensor on the tamp pad stops the motion a quarter-inch from the product where the label is blow onto the product. This non-contact method of label application is perfect for labeling recessed areas on products such as clamshells and containers with raised edges. This system applies labels up to 4.7" wide and 6.3" long at speeds up to 164 feet per minute to a tolerance of $\pm 0.05"$.

The versatile unit can be oriented to apply labels to the sides, tops or bottoms of packages. To accommodate various production environments, the Alpha Compact Tamp-Blow can be specified for right- or left-hand applications.

Special Features

- Applies labels from 1.96" x 1.78" (50mm x 40mm) up to 4.7" x 6.3" (120mm x 160mm)
- Operates at speeds up to 164 feet/minute
- Display HMI with an LCD display that provides full access to all adjustment parameters.
- Accurate labeling to within $\pm 0.05"$ (1.5mm)



Weber[®]
Packaging Solutions

Alpha Compact Tamp-Blow *General Specifications*

Dimensions

28.15" x 12.2" x 23.22"
(715mm x 310mm x 590mm)

Weight

48.5 lbs. (22kg)

Electrical

115-230 VAC, 47-63 Hz

Maximum Dispensing Speed

Up to 164' per minute (50m/minute)
depending on label roll width and diameter

Label Roll Size

Up to 12" O.D. (300mm) wound on 3"
(76mm) core

Standard Label Sizes

Min width: 1.96" (50mm)
Max width: 4.7" (120mm)
Min length: 1.78" (40mm)
Max length: 6.3" (160mm)

Application Accuracy

±0.05" (1.5mm)

Temperature

32°-107°F (0°-42° C)

Product Sensing

Photoelectric



Label Printer-Applicators



Reliable.
Economical.
Durable.

Weber[®]
Packaging Solutions

Label Printer-Applicators

The Model 5300 Series The Best in Print-Apply Systems



Weber's Model 5300 label printer-applicators are redefining the meaning of versatility and reliability in pressure-sensitive label printing and application.

The Model 5300 systems provide high-quality label printing, precise label application, unprecedented modularity and 24/7 reliability – all at an affordable price.

Manufactured exclusively by Weber, the Model 5300 systems offer print engines from the industry's top vendors, including Zebra and SATO. They produce text, bar codes and graphic images at 203, 300 or 600 dpi. And optional RFID models combine these printing capabilities with the encoding and verification of RFID inlays to meet the latest EPC protocols.

Print engines output labels from one to seven inches wide and up to 12 inches long. To keep pace with high-volume production lines, compatible print speeds vary from 2 to 16 ips.

The system's modular design provides one standard unit, yet a choice of six distinct methods of label application: tamp-blow, air-blow, direct tamp, swing-tamp, twin-tamp and corner-wrap. All apply labels to a tolerance of ± 0.03 inches.

The Model 5300 series includes a number of noteworthy features that add to its versatility, including browser-based monitoring, numerous inputs/outputs, and the capacity to handle supply rolls up to 2,000 feet long to ensure reduced downtime and eliminate partial changeovers.

Various options include a remote operator interface that can be mounted up to 15 feet from the unit using a cable; label and product sensors for added functionality; and beacon light alerts to signal the status of labels and printer ribbons.



The Model 4300 Pro-Apply Economy & Versatility



Weber's economical Model 4300 printer-applicator features the functionality often limited to higher-duty production systems.

The result is a versatile in-line system that combines high-quality label printing and reliable tamp-blow or swing-tamp application that ensures fast, accurate pressure-sensitive labeling.

Each unit is equipped with an on-demand, thermal/thermal-transfer print engine that:

- Applies labels up to 6" wide x 6" long at speeds up to 16 ips.
- Prints text, bar codes and graphic images @ 203, 300 or 600 dpi
- Non-contact, tamp-blow application
- Accurate labeling to within ± 0.03 "

Several standard tamp-pad sizes are available, and are provided in quick-change configurations. In just a few seconds, the tamp-pad can be removed and another fastened in its place to handle a different size label.

Standard features include durable anodized aluminum construction, an integrated user interface with LCD display, numerous inputs/outputs to facilitate the use of a product sensor or other optional accessories, and stepper motor-driven rewind.

T-Base Stand

Our heavy-duty T-base stands are ideal for Weber's entire line of label applicators and printer-applicators. Constructed of rugged tubular steel and fitted with over-sized casters, the adjustable stands make it easy to position or move your Weber label system.





The Model LA-6000 High-Speed, Variable-Height

Weber's new LA-6000 high-speed variable-height print-apply system will label passing cartons of varying heights quickly, accurately and efficiently.

Using the tamp-blow method, the LA-6000 can print and apply up to 40 labels per minute (dispensing output depends on label size, text change and dispensing stroke) to products that vary in height up to 19.68" (500mm). And label placement accuracy is ± 0.03 " (1mm).

The servo motor driven actuator will ensure label application at up to 2250 cycles per hour depending on label size. Carbon fiber components reduce the weight of moving parts for higher labeling speeds.

And with the LA-6000's modular design and large 13.8" O.D. label rolls, you can print and apply labels with a minimum of downtime.

A sensor initially determines the height of the approaching product for labelling and then the applicator moves to the correct position at high speed. This reduces the travelling distance for label application, allowing the LA-6000 to simultaneously label more accurately and up to 50 percent faster than a label printer-applicator with a pneumatically driven cylinder.

The Model 5300 Twin-Tamp One Carton, Two Labels



The Model 5300 Twin-Tamp systems are specifically engineered to print a pair of labels and apply them to adjacent panels of cartons in a single operation.

Our Twin-Tamp systems are available with a choice of print engines to provide 203-, 300- or 600-dpi label imprinting. Handling a range of label sizes up to six inches wide and six inches long, each system prints information at speeds programmable up to 16 ips. Label placement is accurate to ± 0.03 inches.

When the initial label is printed and peeled from its liner, it is fed onto a tamp pad and retained by a vacuum. The tamp pad is mounted to a 90-degree swing arm that reaches across a conveyor to blow the label on to the front panel of a moving carton. Upon the arm's return, a second label is printed and a separate straight-line stroke applies that label to the side of the carton.



The systems also can be configured to label side and rear panels, or single panels. Use two Twin-Tamps for a 4-sided labeling solution.



Model 5300 Corner-Wrap



Model 5300 RFID



Model 5300 Split-Tamp

Single Source Supplier

The Right Labels

It's important to find the best labels for your packaging line. Not all labels are reliable when it comes to dispensing and adhesion. A good deal on labels doesn't pay off if they don't work well in your system. We provide the best labels, tags, RFID smart labels and printer ribbons that ensure compatibility with all of our labeling systems.

Weber manufactures a broad selection of pressure-sensitive custom, variable-imprint labels, and tags, including ones for challenging applications like cold-storage labels and wet environments. And we also make a wide array of blank stock labels in white and various colors. With over 100 different label facestock and adhesive combinations available to us, our media experts can help determine the label best suited to a specific application.

Weber also is the source for eye-catching prime labels. Your label is your brand identifier that reaches out from the store shelf to your customers. Make sure it looks great and works correctly for your application.

Using water-based, UV flexographic, or rotary screen printing methods — in addition to the newest digital technology — we manufacture reliable high-quality labels. Weber offers a huge selection of materials, including paper, film and vinyl, plus specialty materials for foil accents, the no-label look, resealable constructions, and much more.

Also available are system-compatible thermal-transfer printer ribbons for label printers, printer-applicators, and RFID printer-encoders. We have the right ribbon, whether economical or long-lasting resin, to match your requirements.

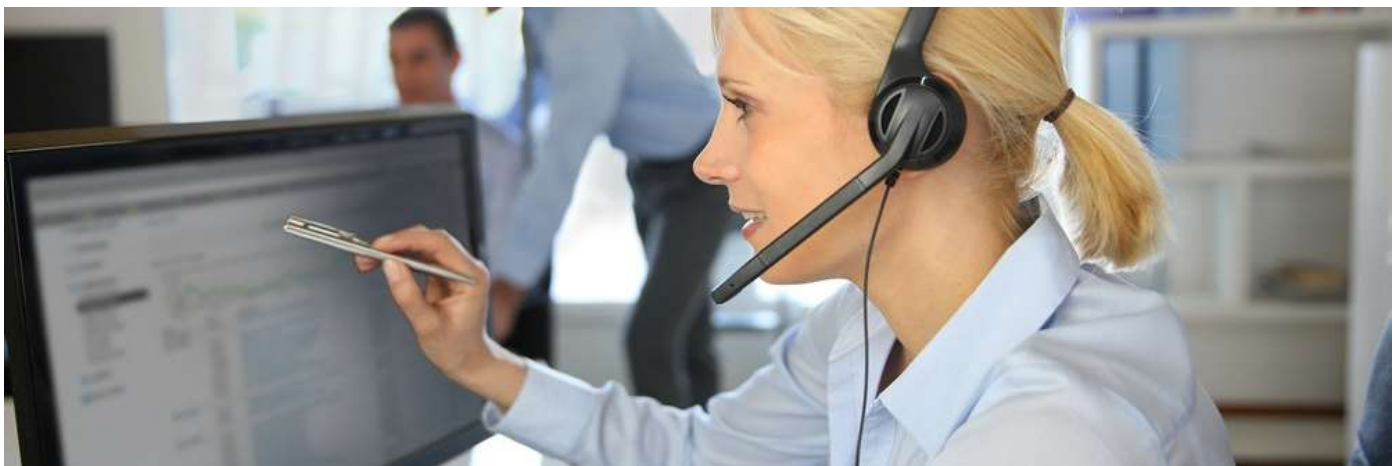

Service & Support

When you purchase a labeling system from Weber, you have a labeling partner who will provide you with continued support.

And that support starts right from the beginning with our direct account managers. As true labeling experts, they will examine your labeling problem and find the most cost-efficient method for solving it. Our account managers stand by you through installation and training as well.

After your system is operational, our nationwide service organization has the expertise to keep it operating at peak efficiency. If a problem should arise, we promise prompt service to get you up and running again.

For additional hardware or software support, or questions about your labeling application, our product support specialists are just a phone call away. Additionally,

our customer service representatives are equipped with the latest on-line order-entry systems to expedite your requests.

Customer satisfaction is Weber's number-one priority, which is reflected by our Corporate Mission Statement:

Our Success comes from helping our customers grow. ***Our Commitment*** is to bring new technologies to market that improve packaging automation, product identification and brand recognition. ***Our Team*** is agile, creative, responsive and conscientious toward our customers, our community and our environment.

For more information or to be put in touch with your local direct account manager, please call **1.800.843.4242** or email **info@weberpackaging.com**.